

**1**  
Colocar referencia en la cara exterior y atornillar.  
Place the reference from the front side and screw.  
Poser l'indicateur de position à la face frontal de la porte et visser

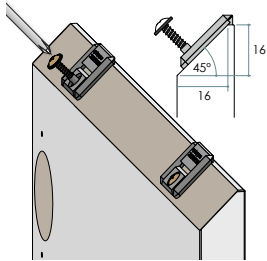

**2**  
Quitar referencias  
Remove references  
Retirer les indicateurs de position

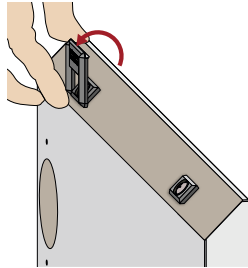

**3**  
Aplicar adhesivo  
Apply adhesive  
Appliquer l'adhésif

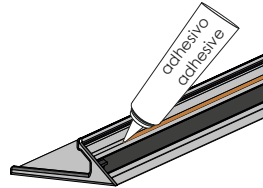

**4**  
Colocar desde la cara interior.  
Place the handle from the back side.  
Situer le pognin retenant par l'arrière de la porte

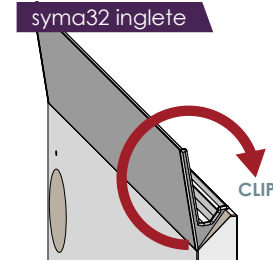

**5**  
Girar hacia la cara exterior hasta oír ¡click!  
Push handle down towards the front side until you hear ¡click!  
Tourner jusqu'au clic

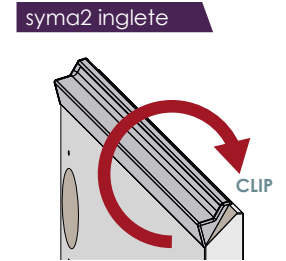

Medidas a considerar  
Measurements to consider  
Mesures à prendre en compte

Longitud tirador - número de clips  
Handle length - number of clips  
Longueurs de poigné - numéro de clips

Componentes  
Components  
Composants

Acabados  
Finishes  
Finitions

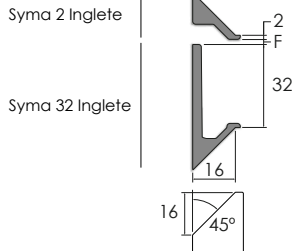

Grosor de la puerta superior a 18 mm  
Door's thickness higher than 18 mm  
Épaisseur de la porte supérieur à 18 mm

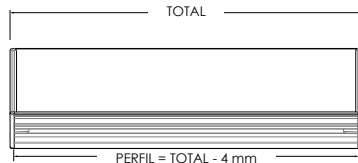

Longitud perfil | Profile length | Longueur profilé = TOTAL - 4 mm

- 2 clips** — tiradores menores de 700 mm  
handles under 700 mm  
poignées inférieures à 700 mm
- 3 clips** — tiradores de 800 a 1600 mm  
handles from 800 up to 1600 mm  
poignées de 800 à 1600 mm
- 4 clips** — tiradores mayores de 1700 mm  
handles longer than 1700 mm  
poignées supérieures à 1700 mm

**Perfil de Aluminio**  
Aluminum profile  
Profile aluminium

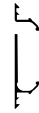

**Terminales**  
Caps  
Embouts

syma32 inglete



syma2 inglete



**Clips**

**35** plata mate  
mat silver  
argenté mat

**04** plata brillo  
chrome effect  
efect chrome

**60** antracita  
anthracite  
anthracite

**50** inox mate - champagne  
mat inox - champagne  
inox mat - champagne

**52/52M** negro brillo / negro mate  
gloss black / matt black  
noir brillant / noir mat

**01/01M** blanco brillo / blanco mate  
gloss white / matt white  
blanc brillant / blanc mat

Montaje de terminales | End caps assembly

Encajar el terminal con un martillo de nailon para evitar daños

Assemble end caps using a rubber mallet to avoid damages

Utilisez un mallet en caoutchouc pour installer les embouts et éviter les dommages

